

Madison, Wisconsin

# CITY OF MADISON

## CITY ENGINEERING DIVISION

### DEPARTMENT OF PUBLIC WORKS

# PLAN OF PROPOSED IMPROVEMENT

PUBLIC IMPROVEMENT PROJECT APPROVED

NOVEMBER 20, 2018

BY THE COMMON COUNCIL OF MADISON, WISCONSIN

PUBLIC IMPROVEMENT DESIGN APPROVED BY:

*Christy L.* 6-7-19  
City Engineer Date

SIDEWALK DESIGNED BY:



INDEX OF SHEETS - STREETS

SHEET NO.	TITLE
1	TITLE
D1	TYPICAL SECTIONS
EC1-EC2	EROSION CONTROL PLANS
P1	AMERICAN PARKWAY PLAN & PROFILE
P2-P3	WRIGHT STREET PLAN & PROFILE
U1	AMERICAN PARKWAY UTILITY PLAN & PROFILE
U2	STORM SEWER SCHEDULE
X1-X2	AMERICAN PARKWAY CROSS SECTIONS
X3-X7	WRIGHT STREET CROSS SECTIONS

## NEW SIDEWALK INSTALLATION - 2019

CITY PROJECT NO. 11985

CITY CONTRACT NO. 8293

CONVENTIONAL SIGNS	
FIELD VERIFY ALL UTILITY LOCATIONS	
GAS	— G —
STORM SEWER	— ST —
SANITARY SEWER	— SAN —
WATER	— W —
OVERHEAD ELECTRIC	— OH —
POWER POLE	⊕
ADA COMPLIANT RAMP W/ DETECTABLE WARNING FIELD	
COMBUSTIBLE FLUIDS	

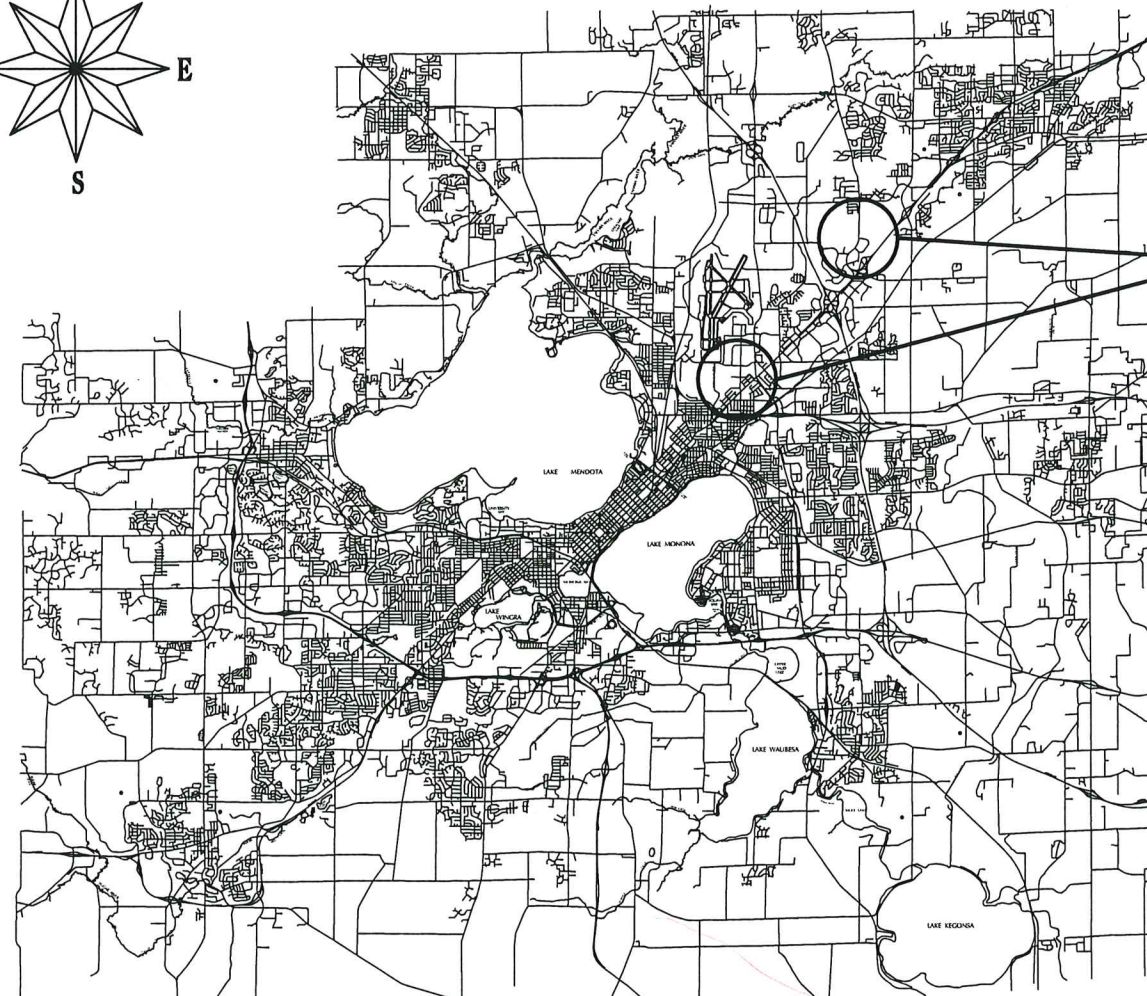
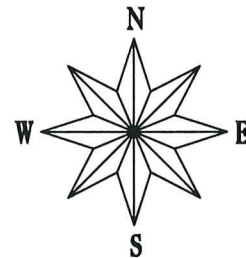

PROJECT LOCATIONS

NOTES:

ALL GUTTERS SHALL DRAIN WITH A MINIMUM GRADE OF 0.50% TOWARD STORM SEWER INLETS.

SIDEWALK RAMPS AND CURB THRU SIDEWALK RAMPS SHALL HAVE A MAXIMUM SLOPE OF 1" PER 12". SIDEWALK AND CURB RAMPS SHALL BE CONSTRUCTED WITH A SIDE SLOPE OF 1.50% UNLESS OTHERWISE SPECIFIED. SIDEWALK SHALL HAVE A MINIMUM LONGITUDINAL SLOPE OF 0.50% AND A MAXIMUM LONGITUDINAL SLOPE OF 5.00% EXCEPT WHERE STREET GRADES EXCEED 5.00%.

PLOT SCALE: \_\_\_\_\_

PLOT NAME: \_\_\_\_\_

ORIGINATOR: CITY OF MADISON, STREETS DIVISION

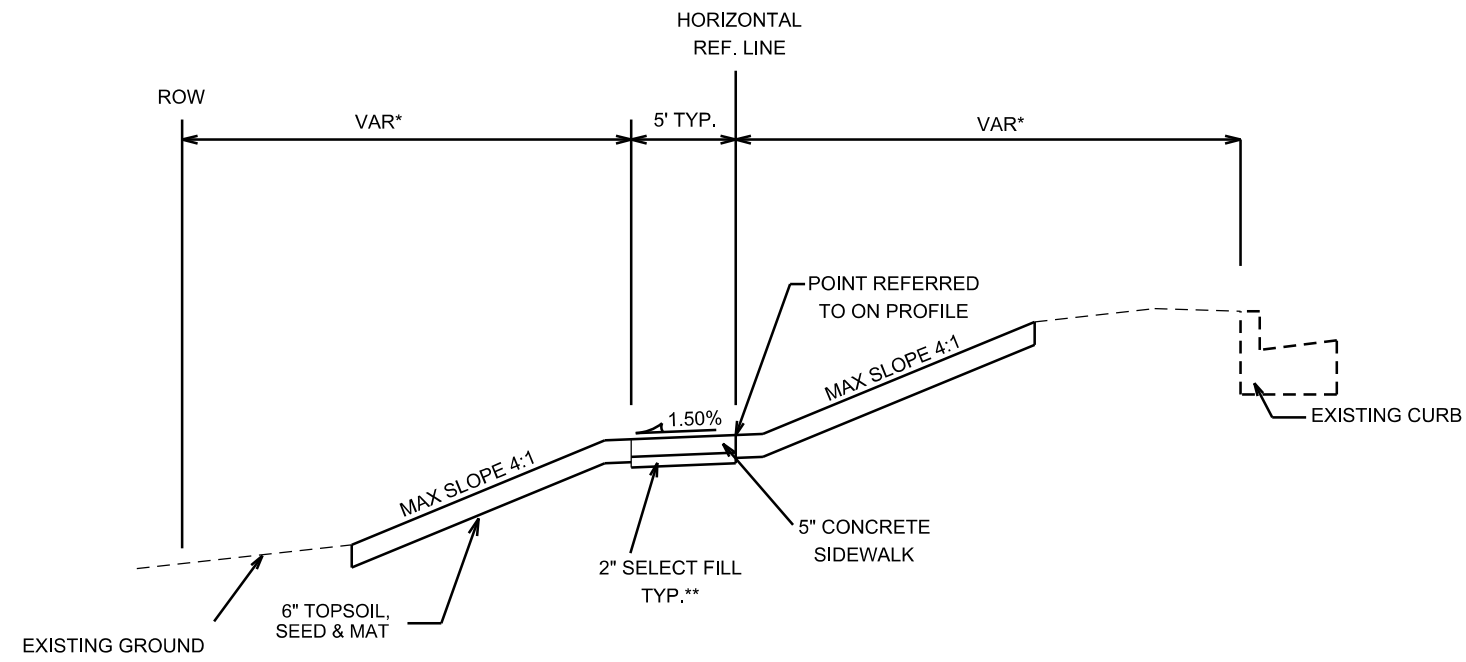

**TYPICAL SECTION**  
WRIGHT STREET SIDEWALK  
STA 0+00 TO STA 9+75  
NOT TO SCALE

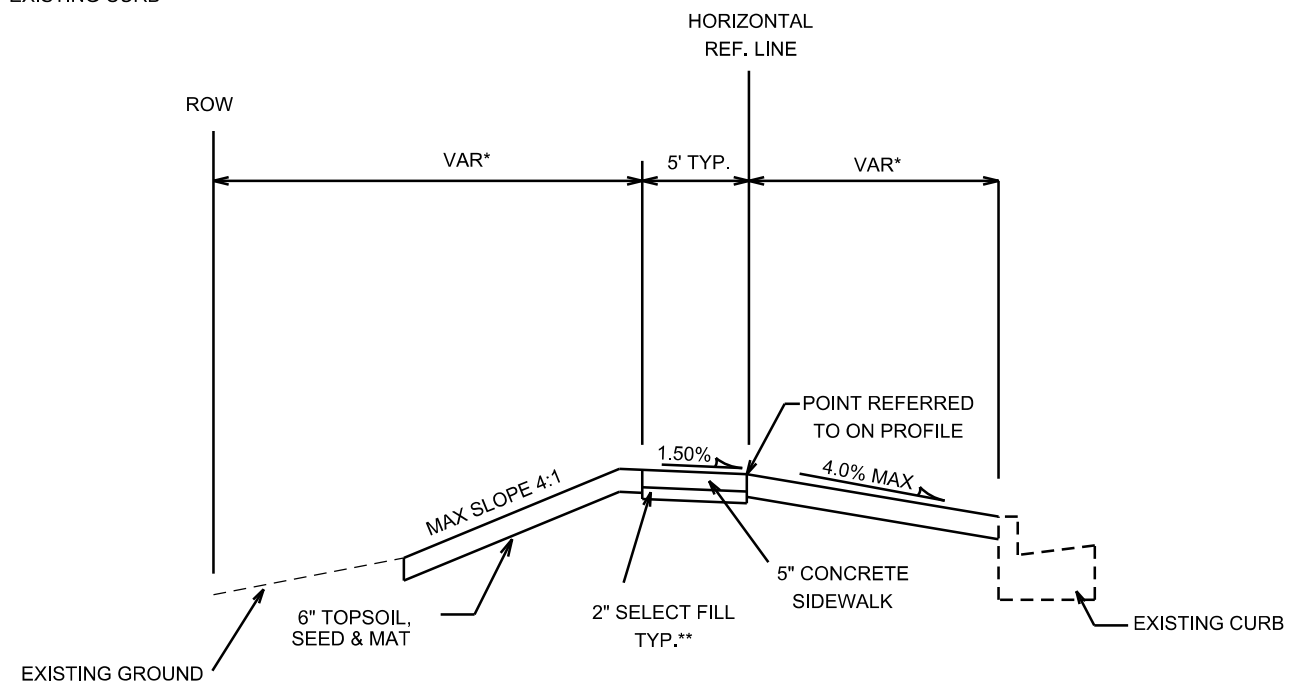

**TYPICAL SECTION**  
WRIGHT STREET SIDEWALK  
STA 9+75 TO STA 10+62  
NOT TO SCALE

**NOTES:**

\* SEE PLANS AND CROSS SECTIONS FOR DETAILS AND DIMENSIONS

\*\* 3" OF CRUSHED AGGREGATE BASE COURSE GRADATION 3 SHALL BE PLACED UNDER THE SIDEWALK WHERE THE CENTERLINE GRADE OF THE STREET EXCEEDS 5%.

PLOT SCALE: \_\_\_\_\_

PLOT NAME: \_\_\_\_\_

REV. DATE: \_\_\_\_\_

ORIGINATOR: CITY OF MADISON, STREETS DIVISION

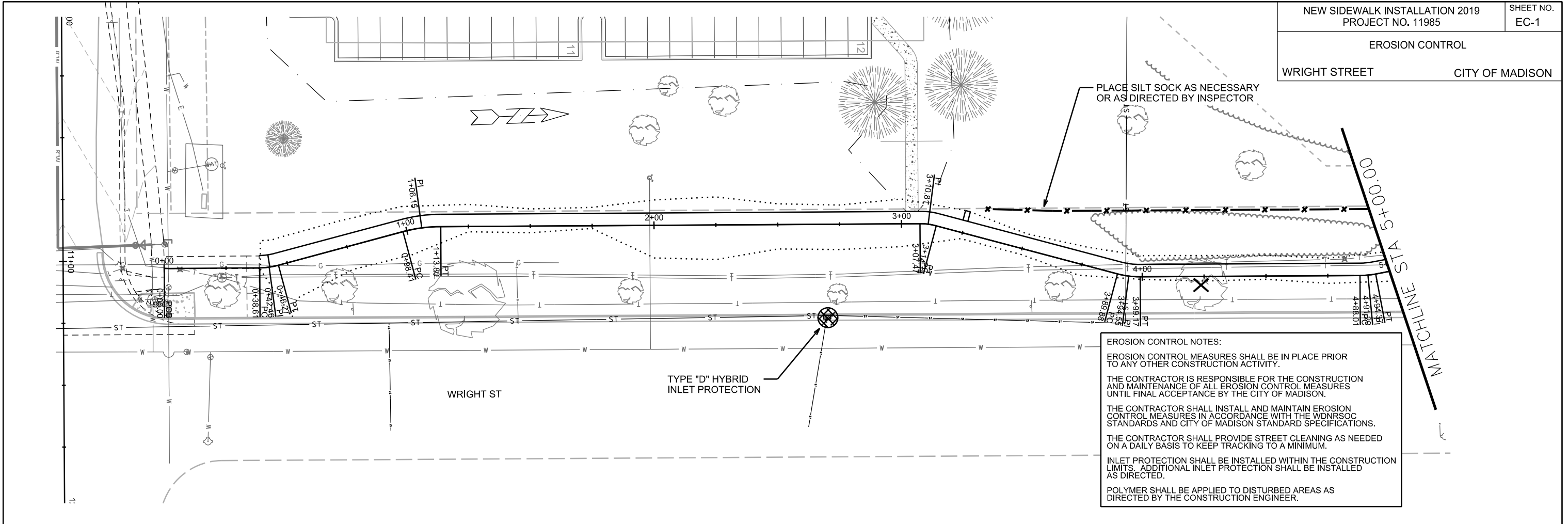

**EROSION CONTROL NOTES:**  
 EROSION CONTROL MEASURES SHALL BE IN PLACE PRIOR TO ANY OTHER CONSTRUCTION ACTIVITY.  
 THE CONTRACTOR IS RESPONSIBLE FOR THE CONSTRUCTION AND MAINTENANCE OF ALL EROSION CONTROL MEASURES UNTIL FINAL ACCEPTANCE BY THE CITY OF MADISON.  
 THE CONTRACTOR SHALL INSTALL AND MAINTAIN EROSION CONTROL MEASURES IN ACCORDANCE WITH THE WDNR SOC STANDARDS AND CITY OF MADISON STANDARD SPECIFICATIONS.  
 THE CONTRACTOR SHALL PROVIDE STREET CLEANING AS NEEDED ON A DAILY BASIS TO KEEP TRACKING TO A MINIMUM.  
 INLET PROTECTION SHALL BE INSTALLED WITHIN THE CONSTRUCTION LIMITS. ADDITIONAL INLET PROTECTION SHALL BE INSTALLED AS DIRECTED.  
 POLYMER SHALL BE APPLIED TO DISTURBED AREAS AS DIRECTED BY THE CONSTRUCTION ENGINEER.

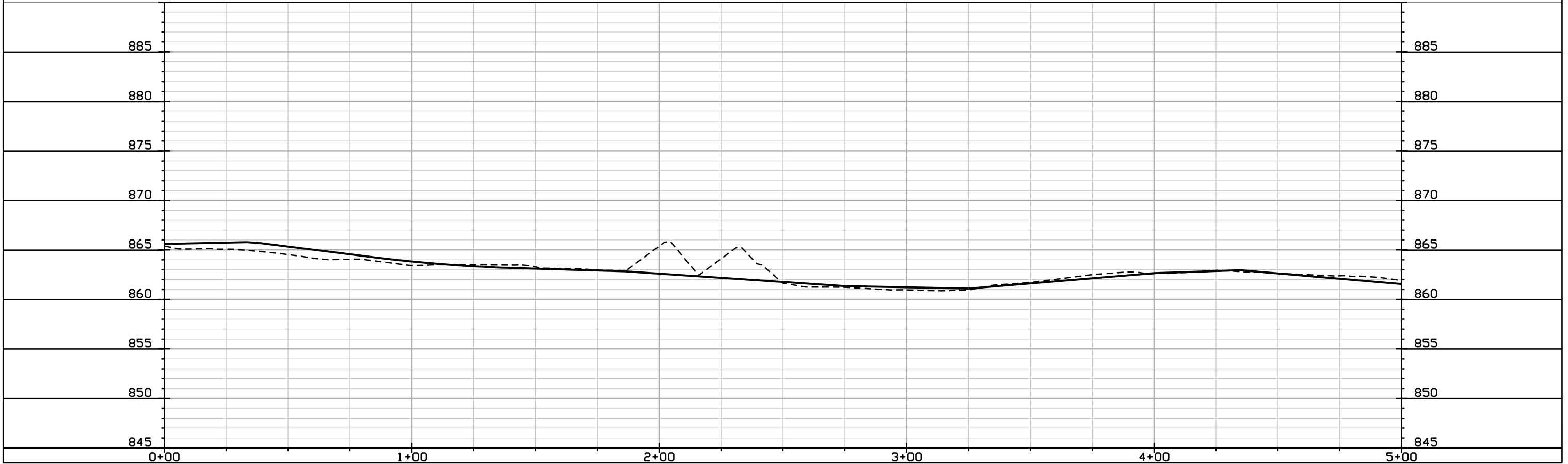

PLOT SCALE: \_\_\_\_\_

PLOT NAME: \_\_\_\_\_

REV. DATE: \_\_\_\_\_

ORIGINATOR: CITY OF MADISON, STREETS DIVISION

EROSION CONTROL

WRIGHT STREET CITY OF MADISON

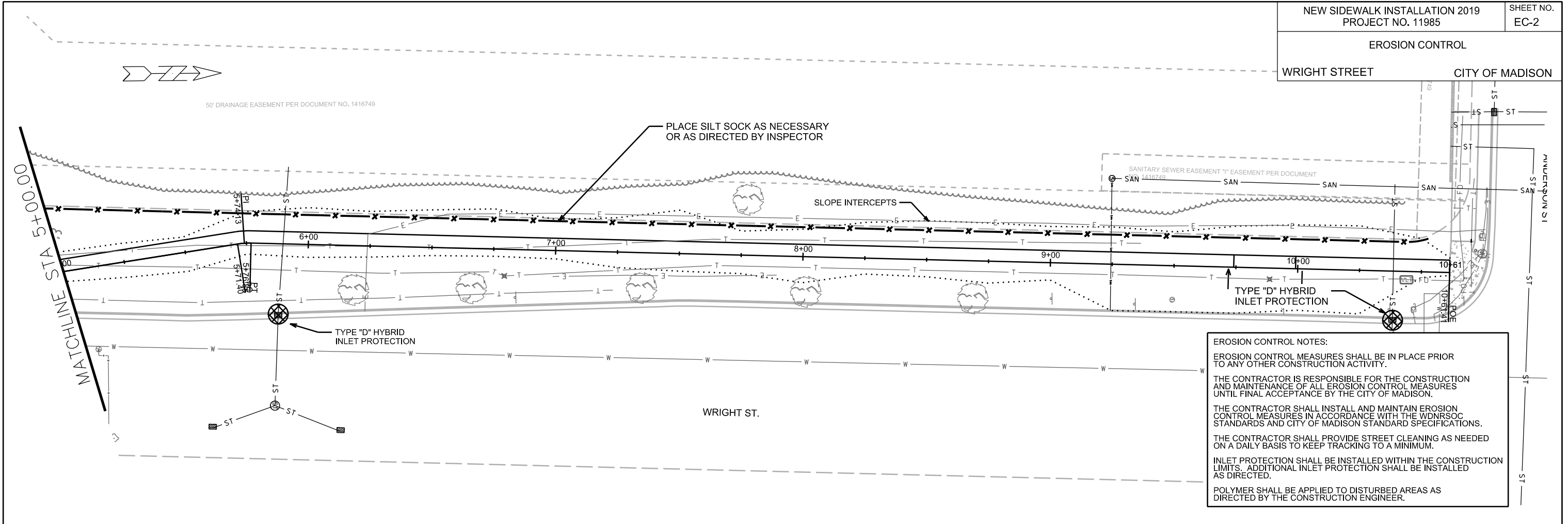

**EROSION CONTROL NOTES:**

- EROSION CONTROL MEASURES SHALL BE IN PLACE PRIOR TO ANY OTHER CONSTRUCTION ACTIVITY.
- THE CONTRACTOR IS RESPONSIBLE FOR THE CONSTRUCTION AND MAINTENANCE OF ALL EROSION CONTROL MEASURES UNTIL FINAL ACCEPTANCE BY THE CITY OF MADISON.
- THE CONTRACTOR SHALL INSTALL AND MAINTAIN EROSION CONTROL MEASURES IN ACCORDANCE WITH THE WDNR SOC STANDARDS AND CITY OF MADISON STANDARD SPECIFICATIONS.
- THE CONTRACTOR SHALL PROVIDE STREET CLEANING AS NEEDED ON A DAILY BASIS TO KEEP TRACKING TO A MINIMUM.
- INLET PROTECTION SHALL BE INSTALLED WITHIN THE CONSTRUCTION LIMITS. ADDITIONAL INLET PROTECTION SHALL BE INSTALLED AS DIRECTED.
- POLYMER SHALL BE APPLIED TO DISTURBED AREAS AS DIRECTED BY THE CONSTRUCTION ENGINEER.

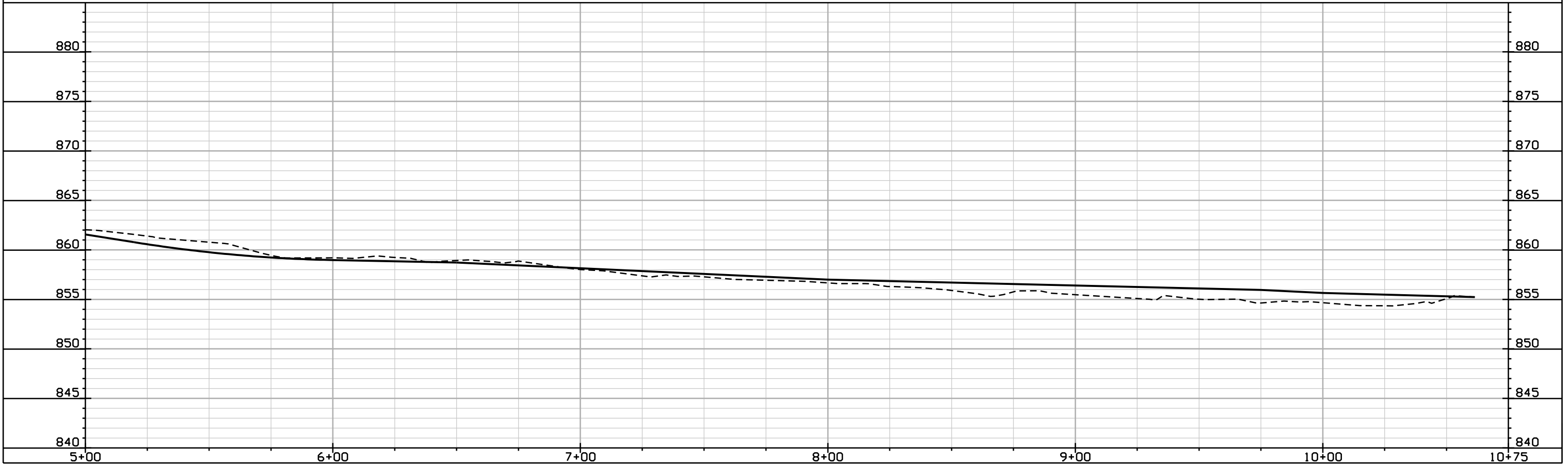

PLOT SCALE: \_\_\_\_\_

PLOT NAME: \_\_\_\_\_

REV. DATE: \_\_\_\_\_

ORIGINATOR: CITY OF MADISON, STREETS DIVISION

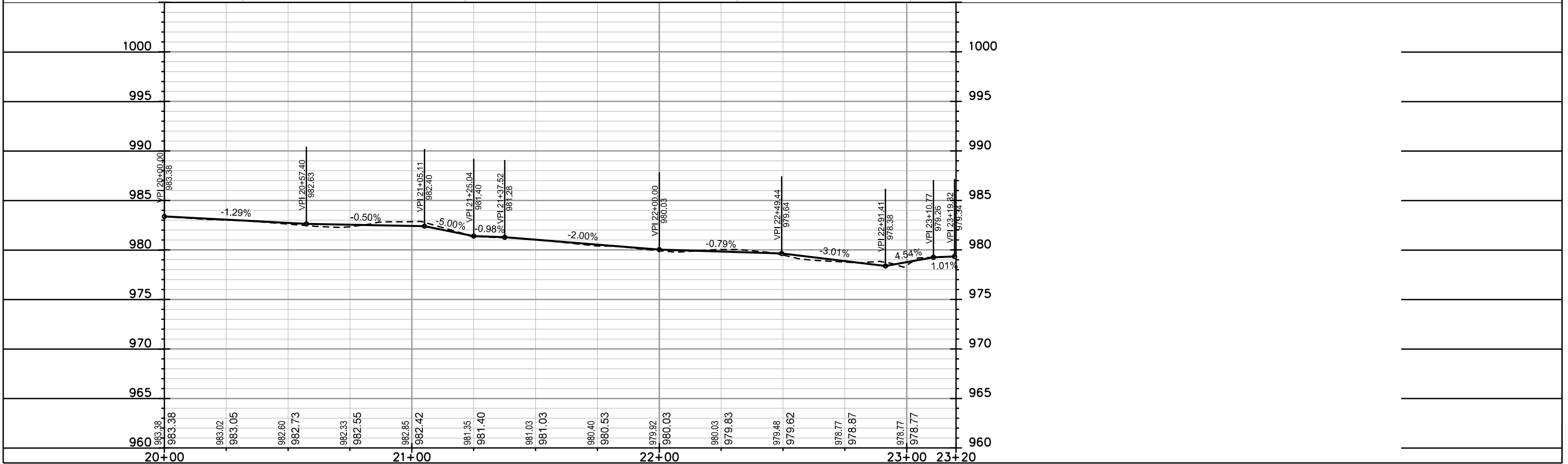
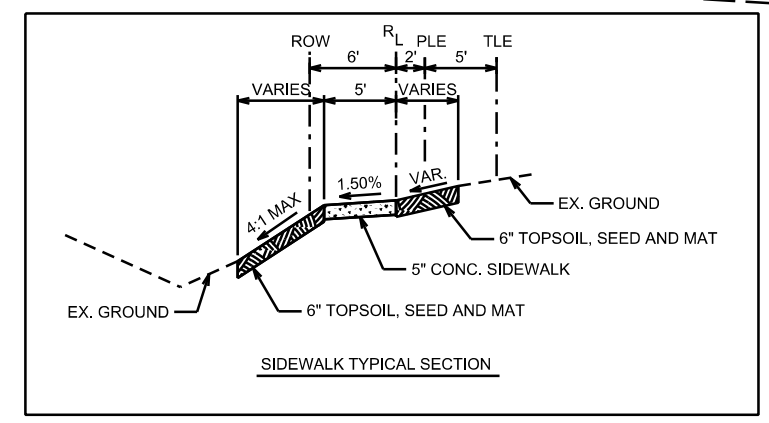
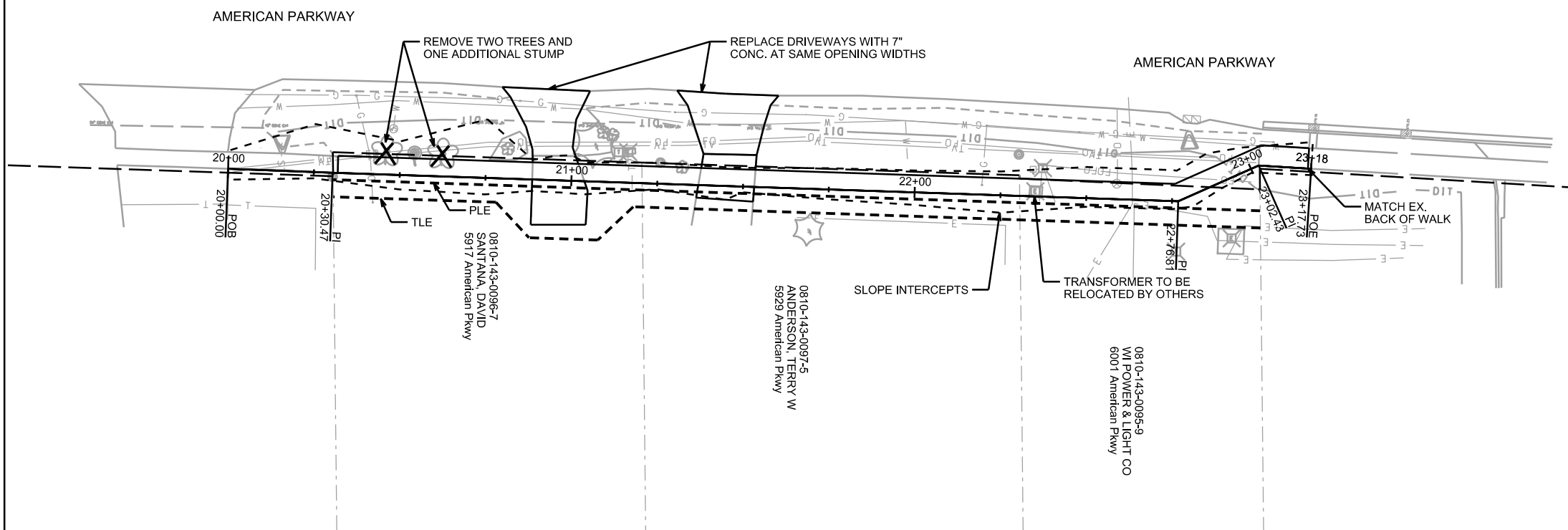

PLOT SCALE: \_\_\_\_\_

PLOT NAME: \_\_\_\_\_

REV. DATE: \_\_\_\_\_

ORIGINATOR: CITY OF MADISON, STREETS DIVISION



PLAN AND PROFILE

WRIGHT STREET CITY OF MADISON

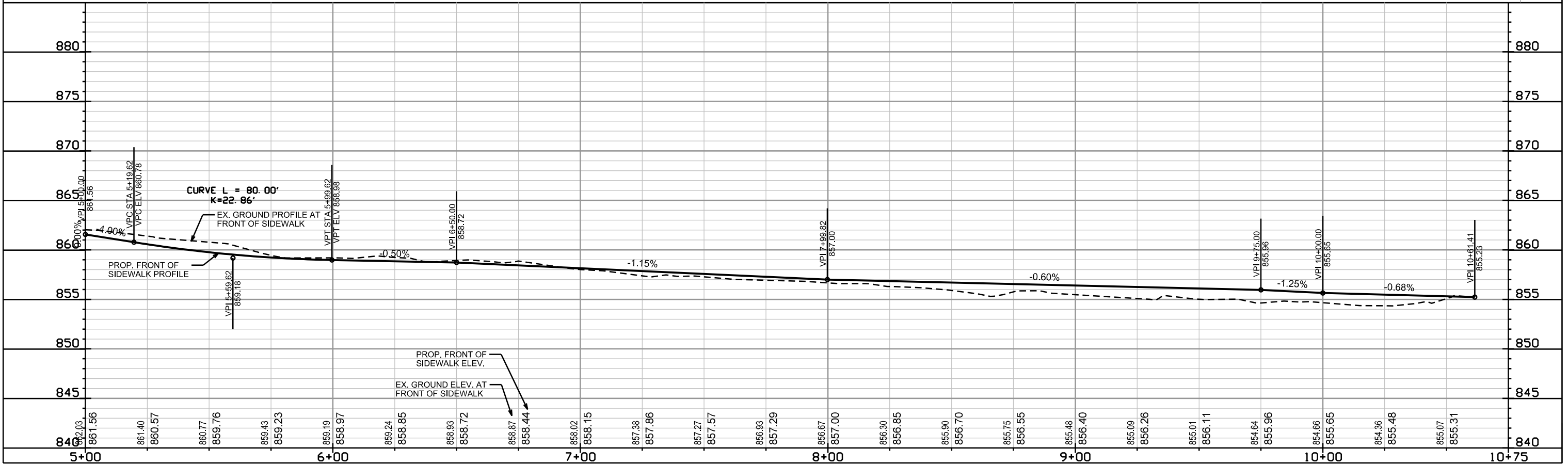
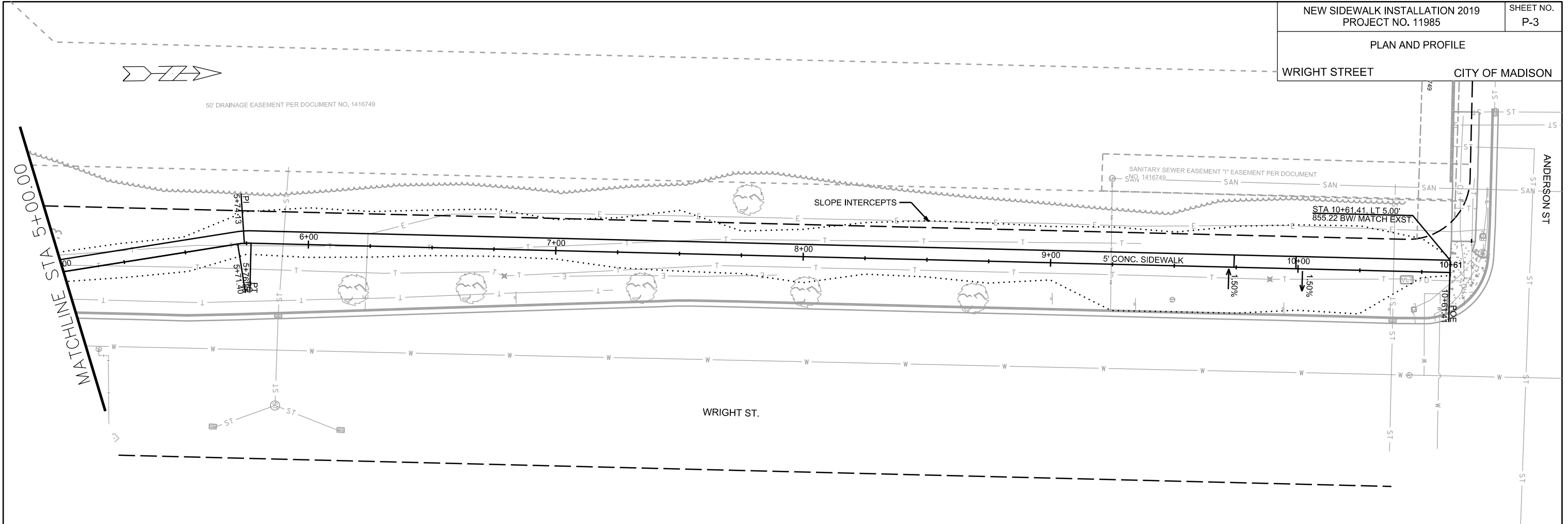

PLOT SCALE: \_\_\_\_\_

PLOT NAME: \_\_\_\_\_

REV. DATE: \_\_\_\_\_

ORIGINATOR: CITY OF MADISON, STREETS DIVISION

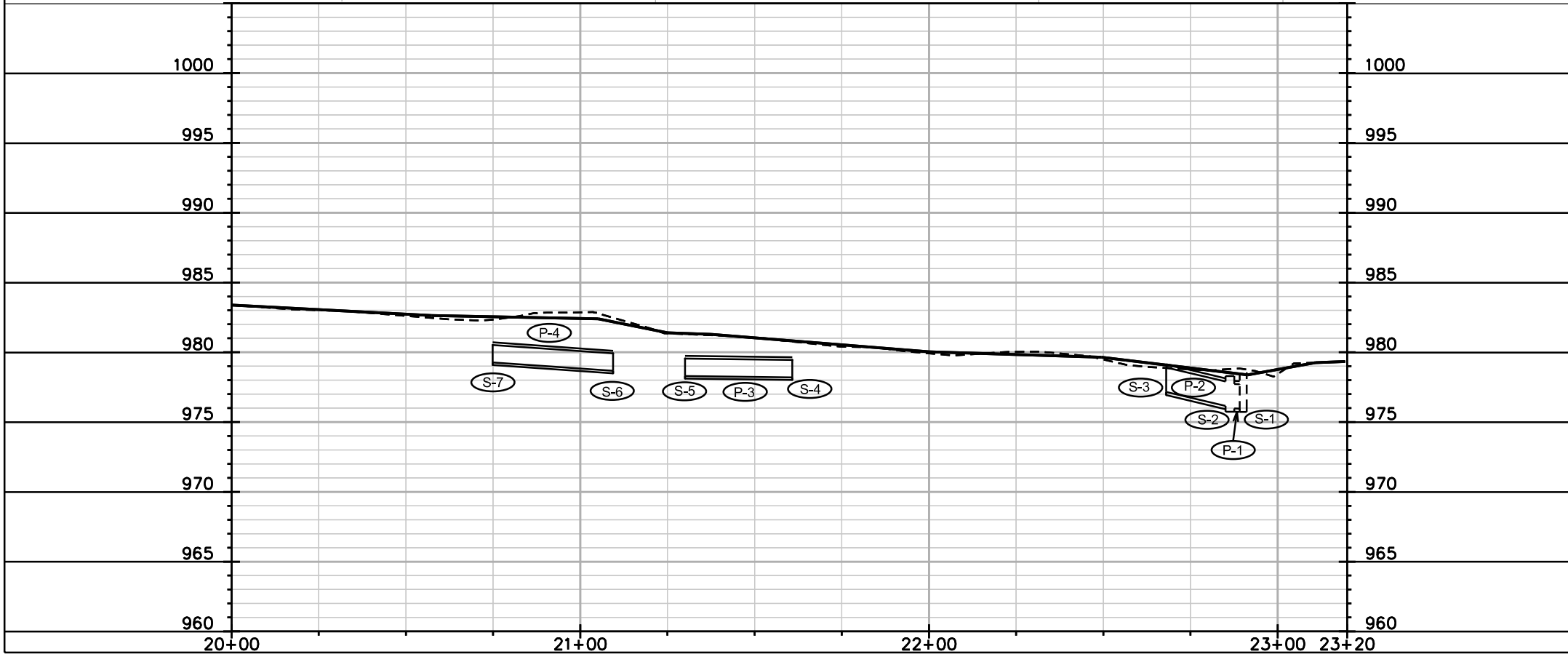
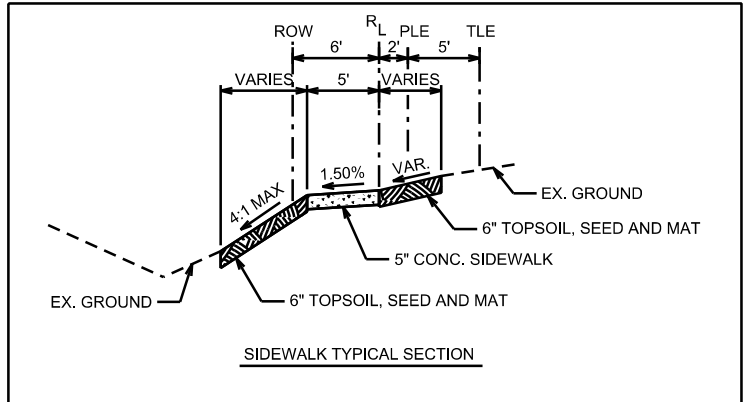
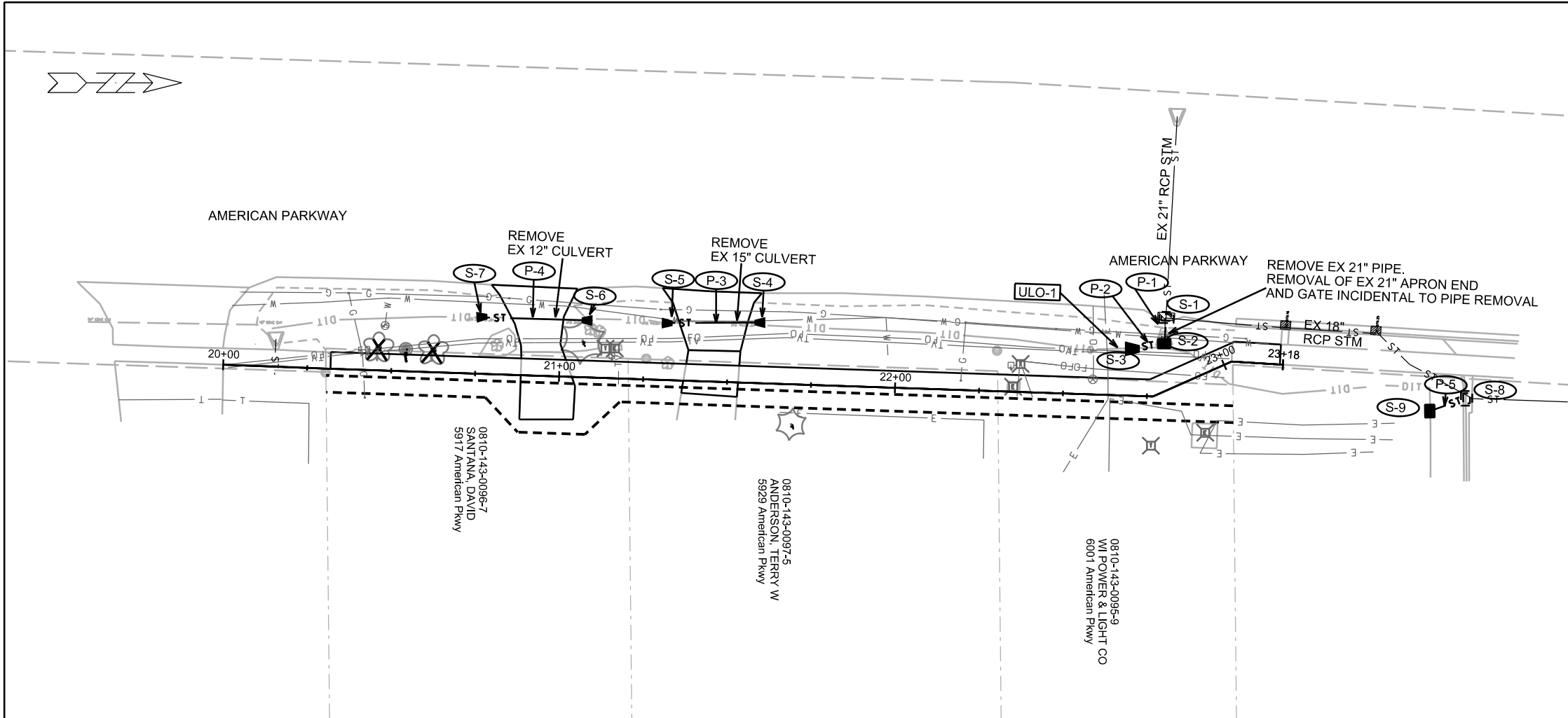

PLOT SCALE: \_\_\_\_\_

PLOT NAME: \_\_\_\_\_

REV. DATE: \_\_\_\_\_

ORIGINATOR: CITY OF MADISON, STREETS DIVISION



# STORM SEWER SCHEDULE

NEW SIDEWALK INSTALLATION 2019	SHEET NO.
PROJECT NO. 11985	U-2
STORM SEWER SCHEDULE	
AMERICAN PKWY	CITY OF MADISON

## PROPOSED STORM STRUCTURES

STRUC. NO.	STATION	LOCATION (OFFSET)	TYPE	TOP OF CASTING	E.I.	DEPTH	NOTES
S-1	22+89.05	LT-18.53	STM TAP	-	975.94	-	TAP EX IN 7115-010
S-2	22+86.29	LT-13.02	H INLET	978.30	975.99	2.31	FP; W/ R-1878-B7G
S-3	22+68.03	LT-13.96	21" APRON END	-	977.16	-	W/ GATE
S-4	21+61.09	LT-17.86	15" RCP APRON END	-	978.20	-	NO GATE
S-5	21+30.04	LT-16.99	15" RCP APRON END	-	978.30	-	NO GATE
S-6	21+09.40	LT-17.07	15" RCP APRON END	-	978.67	-	NO GATE
S-7	20+74.87	LT-16.85	15" RCP APRON END	-	979.27	-	NO GATE
S-8			STM TAP	-	976.90	-	TAP EX IN 7115-005
S-9			H INLET	979.28	977.78	1.50	FP; W/ R-1878-B7G

## PROPOSED STORM PIPES

PIPE NO.	FROM (DNSTM)	TO (UPSTM)	DISCH. E.I.	INLET E.I.	PLAN (PAY) LGTH (FT)	PIPE LGTH (FT)	SLOPE (%)	PIPE SIZE	TYPE	NOTES
P-1	S-1	S-2	975.94	975.99	9	9	0.56%	21"	TYPE I	-
P-2	S-2	S-3	975.99	977.16	12	10	11.70%	21"	TYPE I	-
P-3	S-4	S-5	978.20	978.30	31	31	0.32%	15"	TYPE II	-
P-4	S-6	S-7	978.67	979.27	35	35	1.71%	15"	TYPE II	-
P-5	S-8	S-9	976.90	977.78	9	12	7.33%	12"	TYPE II	-

## REMOVE STORM STRUCTURES

ID NO.	STATION	LOCATION (OFFSET)	TYPE	NOTES
AE 7115-011	22+86.29	LT-13.02	21" APRON END	W/ GATE

## REMOVE STORM PIPES

REMOVE FROM	REMOVE TO	LGTH (FT)	PIPE SIZE	PIPE TYPE	PAID (Y/N)	NOTES
S-1	S-2	9	9	21" RCP	N	APRON END REMOVAL W/ GATE INCIDENTAL TO PIPE REMOVAL
S-4	S-5	31	15"	METAL CULVERT	N	APRON END REMOVALS INCIDENTAL TO PIPE REMOVAL
S-6	S-7	35	12"	PLASTIC CULVERT	N	APRON END REMOVALS INCIDENTAL TO PIPE REMOVAL

## STORM SEWER ULOs

ULO NO.	STATION	LOCATION (OFFSET)	TYPE	NOTES
ULO-1	22+68.03	LT-13.96	FO	-

## STANDARD NOTES:

- ABBREVIATIONS: AE = APRON ENDWALL; RCP = REINFORCED CONCRETE PIPE; HERCP = HORIZONTAL ELLIPTICAL REINFORCED CONCRETE PIPE; DNA = DOES NOT APPLY; SAS = SEWER ACCESS STRUCTURE; LP = LOW POINT INLET STRUCTURE; FP = FIELD POURED STRUCTURE; TR = TOP OF CONCRETE ROOF; NCM = NO CROWN MATCH FOR PIPES; UD = UNDERDRAIN
- APPROXIMATE DISCHARGE E.I. GIVEN, ADJUST E.I. AND PIPE SLOPE IN THE FIELD.
- TOP OF CASTING GRADE GIVEN IS THE TOP OF CURB FOR INLET STRUCTURES AND THE FLOWLINE OF THE CLOSED CASTING FOR SAS's.
- TOP OF CONCRETE ROOF (TR) IS 1.25' BELOW TOP OF CASTING UNLESS OTHERWISE NOTED.
- ALL REINFORCED CONCRETE PIPES TO BE CLASS III UNLESS OTHERWISE NOTED.
- SURVEYOR TO CONFIRM THAT ALL INLET STATION / OFFSETS LINE UP WITH PROPOSED CURB AND GUTTER.
- ALL STRUCTURES CALLED OUT AS FIELD POURED SHALL BE FIELD POURED. ALL OTHER STRUCTURES (NOT INDICATED AS FIELD POURED) SHALL BE SUBMITTED TO CITY ENGINEERING FOR APPROVAL IF PRECAST STRUCTURES ARE PREFERRED. CONTACT ELIA E. ACOSTA OF CITY ENGINEERING AT (608) 266-4096 FOR PRECAST APPROVALS, FAX SHOP DRAWINGS TO (608)264-9275, OR EMAIL SHOP DRAWINGS TO EACOSTA@CITYOFMADISON.COM.

## SPECIFIC NOTES

CROSS SECTIONS  
AMERICAN PKWY CITY OF MADISON

PLOT SCALE: \_\_\_\_\_

PLOT NAME: \_\_\_\_\_

REV. DATE: \_\_\_\_\_

ORIGINATOR: CITY OF MADISON - STREETS DIVISION

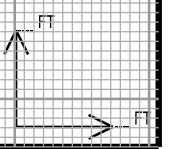
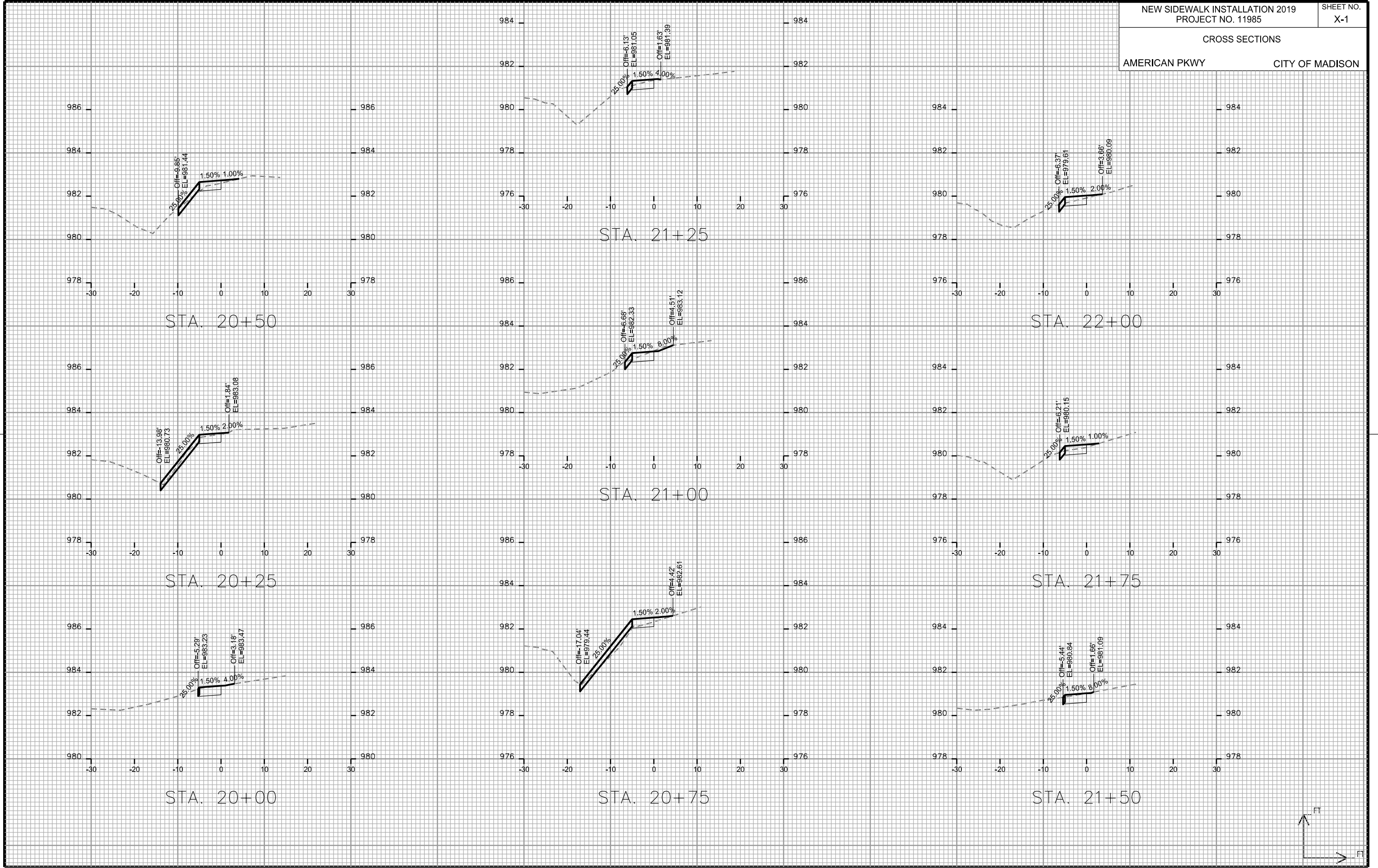

CROSS SECTIONS

AMERICAN PKWY

CITY OF MADISON

PLOT SCALE: \_\_\_\_\_

PLOT NAME: \_\_\_\_\_

REV. DATE: \_\_\_\_\_

ORIGINATOR: CITY OF MADISON - STREETS DIVISION

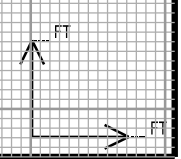
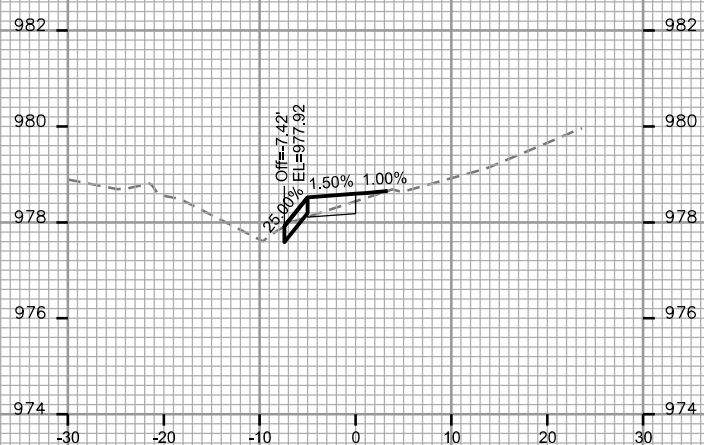
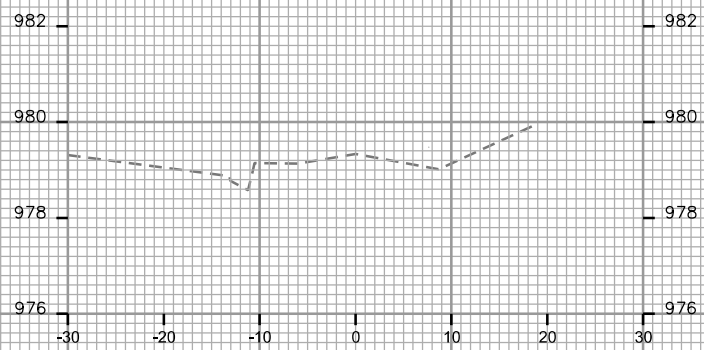
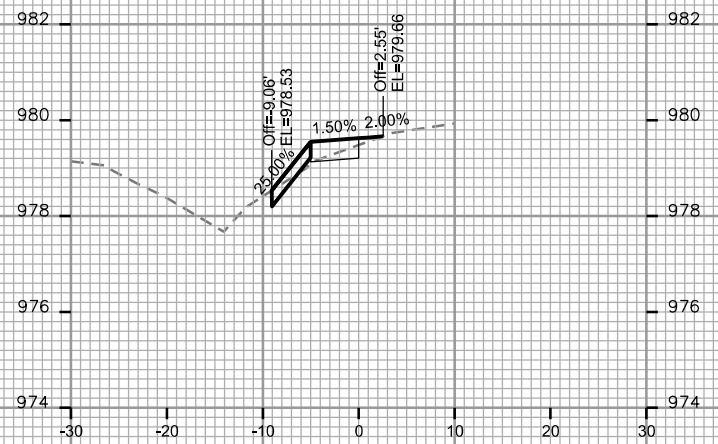
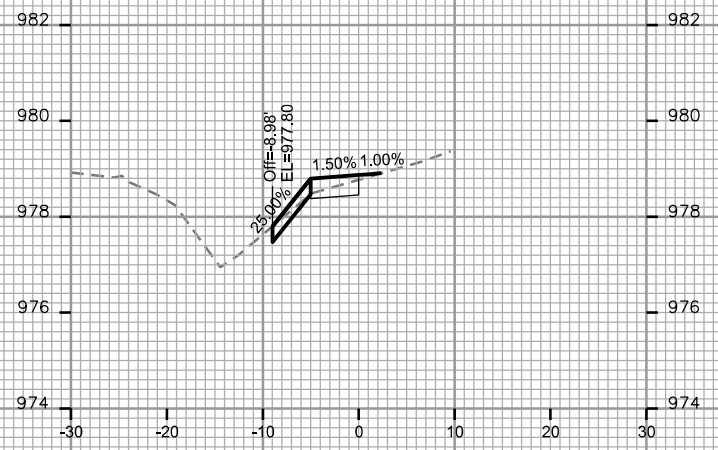

CROSS SECTIONS  
WRIGHT STREET SIDEWALK CITY OF MADISON

PLOT SCALE: \_\_\_\_\_

PLOT NAME: \_\_\_\_\_

REV. DATE: \_\_\_\_\_

ORIGINATOR: CITY OF MADISON - STREETS DIVISION

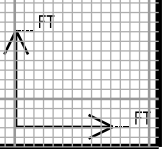
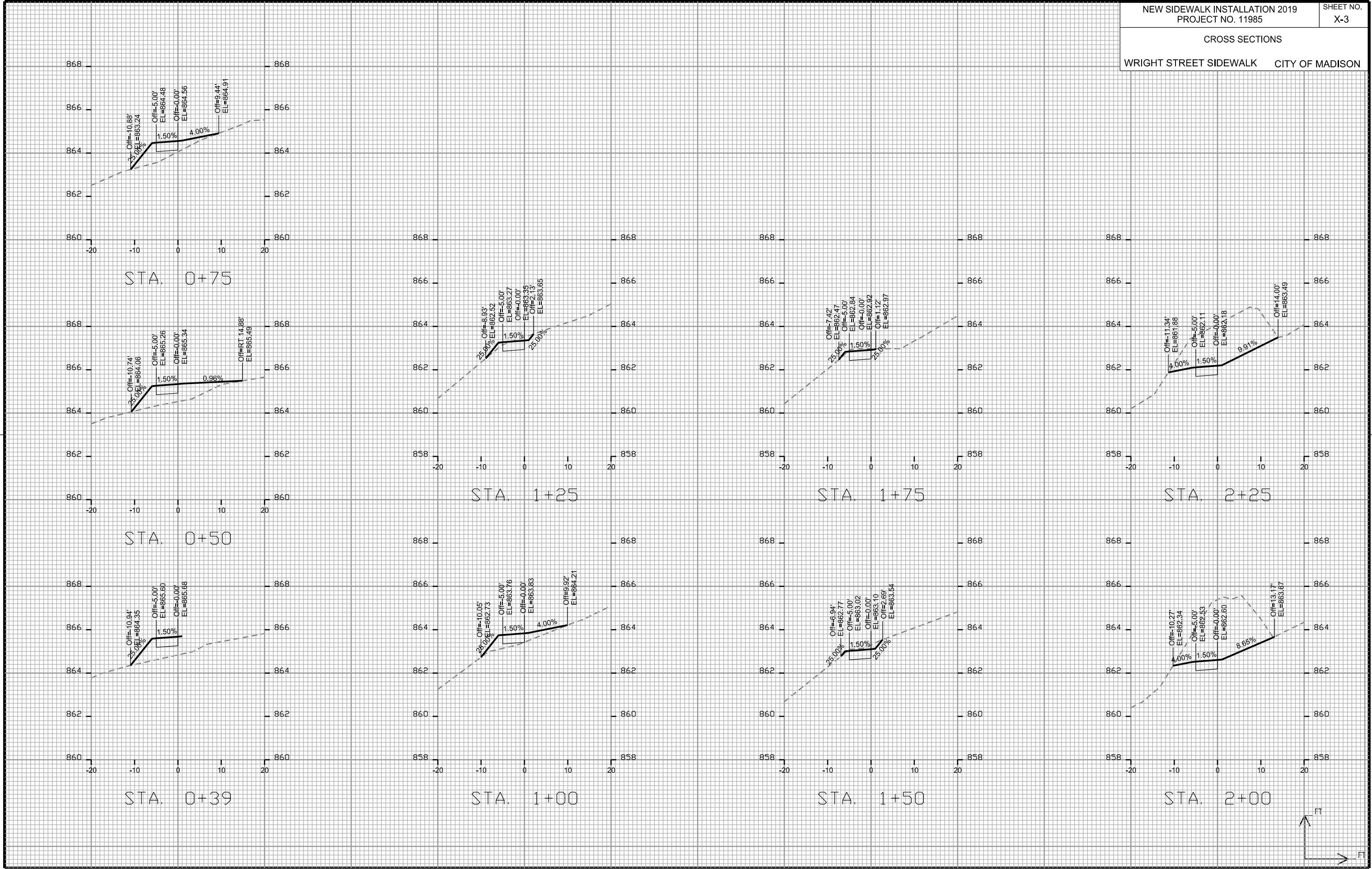

CROSS SECTIONS  
WRIGHT STREET SIDEWALK CITY OF MADISON

PLOT SCALE: \_\_\_\_\_

PLOT NAME: \_\_\_\_\_

REV. DATE: \_\_\_\_\_

ORIGINATOR: CITY OF MADISON - STREETS DIVISION

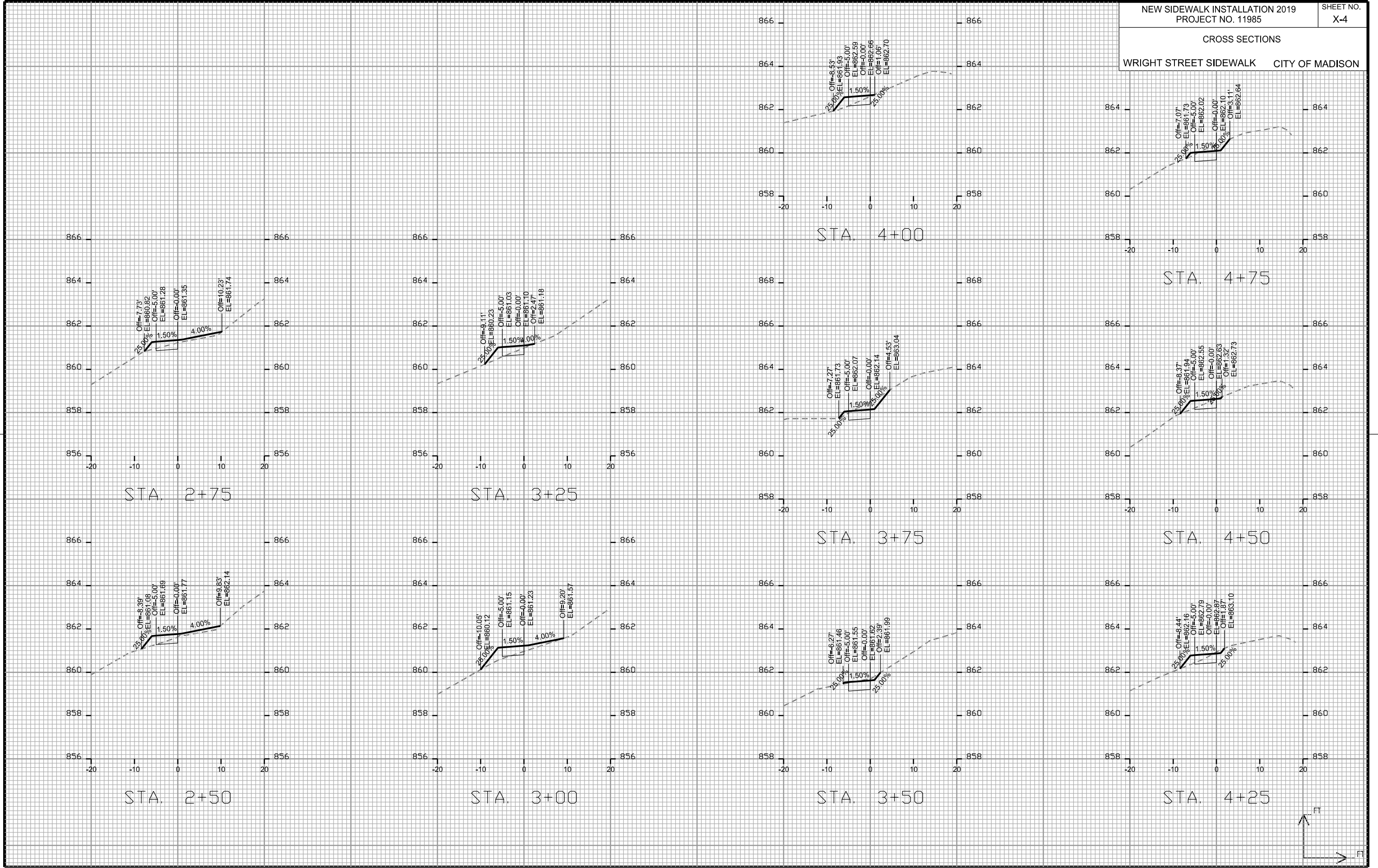

CROSS SECTIONS  
WRIGHT STREET SIDEWALK CITY OF MADISON

PLOT SCALE: \_\_\_\_\_  
PLOT NAME: \_\_\_\_\_

REV. DATE: \_\_\_\_\_

ORIGINATOR: CITY OF MADISON - STREETS DIVISION

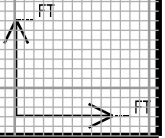
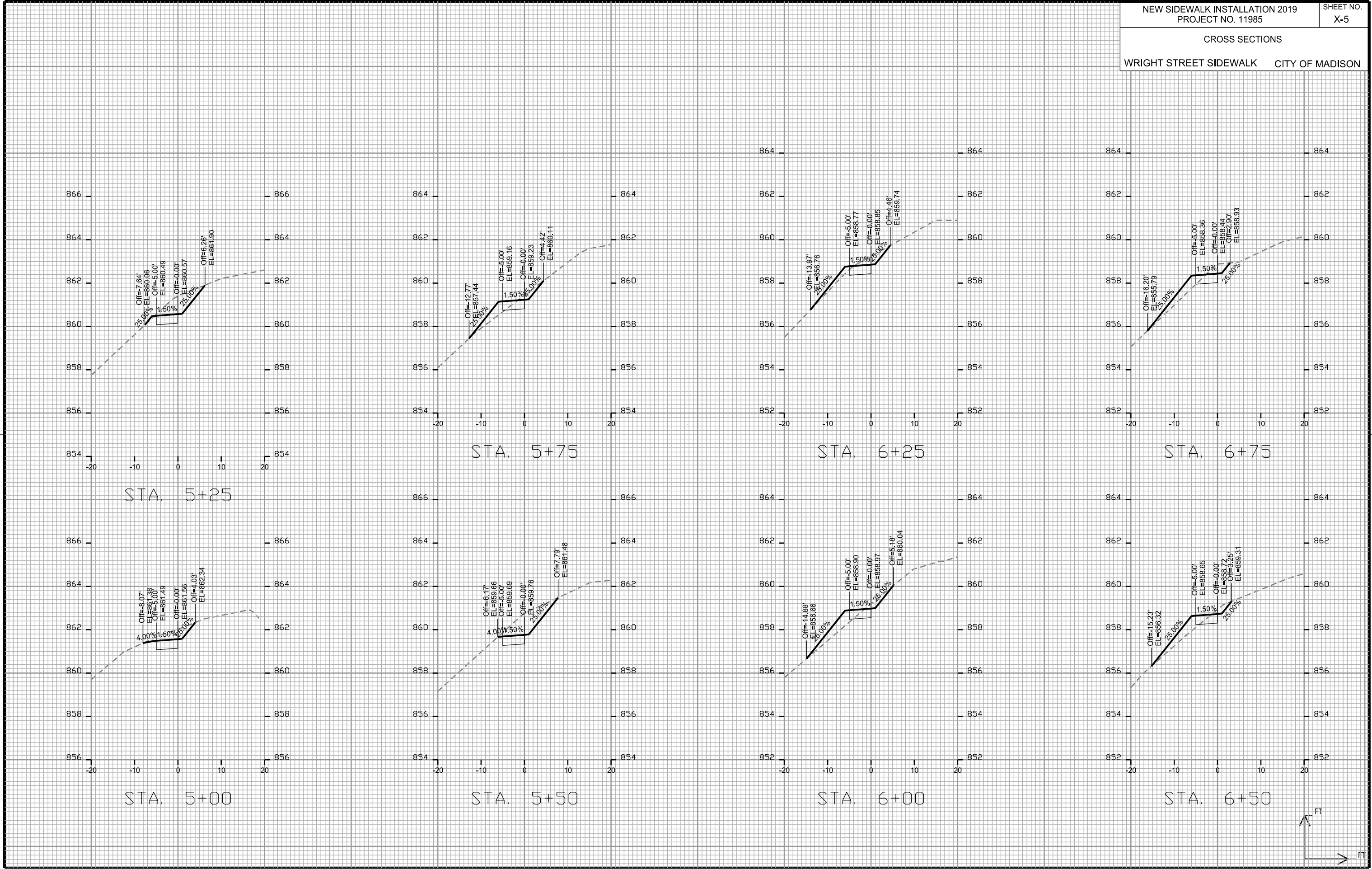

CROSS SECTIONS  
WRIGHT STREET SIDEWALK CITY OF MADISON

PLOT SCALE: \_\_\_\_\_

PLOT NAME: \_\_\_\_\_

REV. DATE: \_\_\_\_\_

ORIGINATOR: CITY OF MADISON STREETS DIVISION

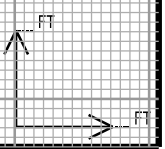
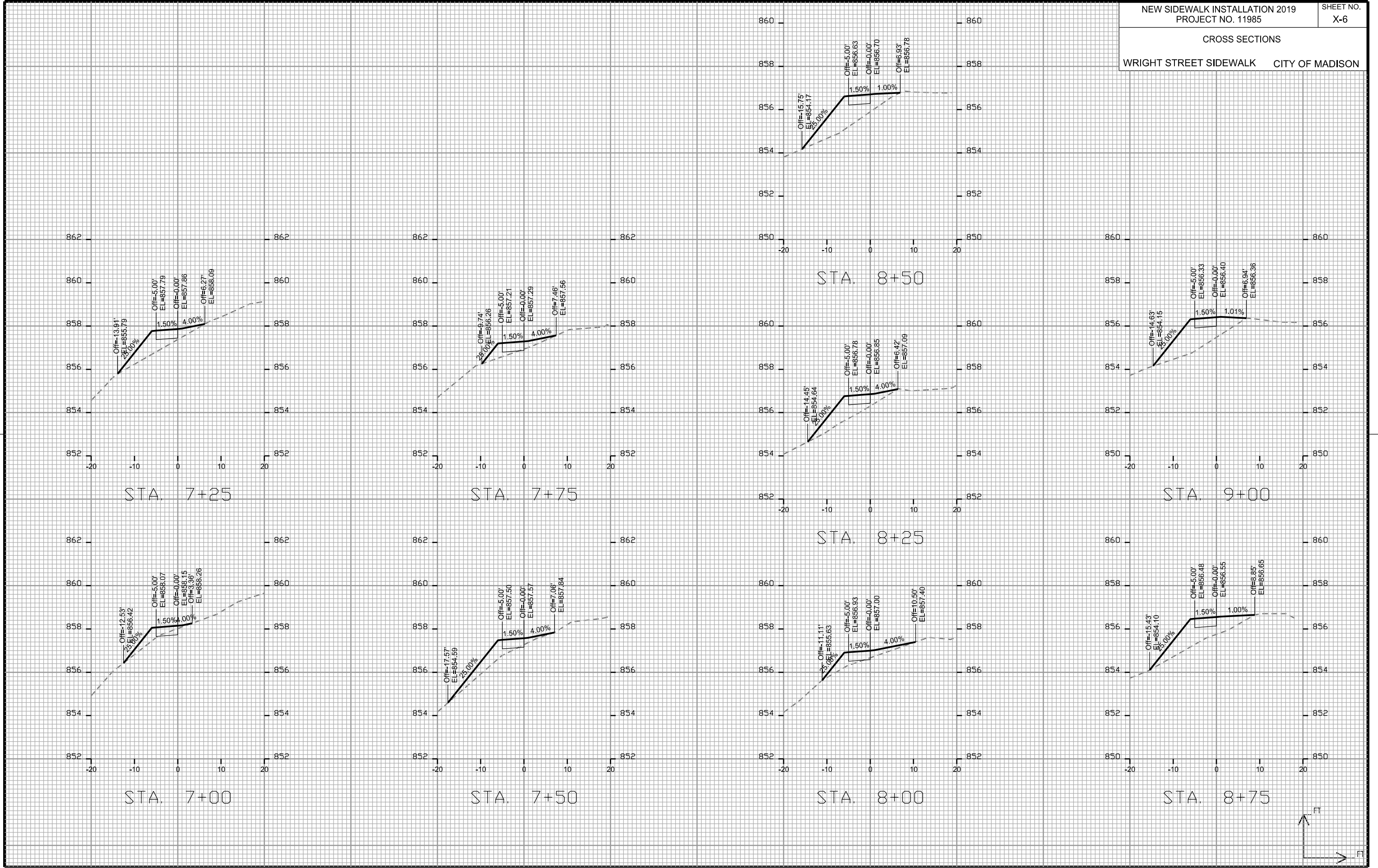

CROSS SECTIONS  
WRIGHT STREET SIDEWALK CITY OF MADISON

PLOT SCALE: \_\_\_\_\_

PLOT NAME: \_\_\_\_\_

REV. DATE: \_\_\_\_\_

ORIGINATOR: CITY OF MADISON - STREETS DIVISION

